

Holiday lettings Sainte-Luce Flat-Apartments



Flat-Apartments ground floor, separate entrance, in a(an) Private estate 2 floors

Setting : quiet, seaside

Capacity : from 2 to 4 person(s)

Bedroom(s) : 1

Room(s) : 3

Sainte-Luce

Martinique

Advert No. 76717

Reservation : +596 (0) 596578501 (Martinique)

www.ihacom.co.uk



Holiday lettings



Flat-Apartments ground floor, separate entrance, in a(an) Private estate 2 floors

- **Ideal for retired people, couples**
- **View :** not overlooked
- **Setting :** quiet, seaside

Assets

- **Parking :**
Parking uncovered : internal, reserved bay.



Surroundings & location



Seaside



Fishing

Leisure

- **Leisure activities less than 20 km / 12 miles :**

Bathing, snorkelling, scuba diving, water skiing, jet ski, windsurfing, sailing, kite surfing, canoeing, golf, tennis, riding school, pony club, pathway, coastal/forest paths, hiking, flying (club), boat trips, paintball, fishing, deep-sea angling, angling, spear fishing

- **Supervised :**

Dive school

- **Attractions and relaxation :**

Bar/pub, discotheque, restaurant, park and garden, nature reserve, museum, local craftshop, racecourse

Surroundings

- **Locality :**

Sea/ocean 330'
Sandy beach 330'
18 hole golf course 12.5mi.
Flying clubs 9mi.
Windsurfing spots 12.5mi.
Surfing spots 12.5mi.
Marina 6mi.
Slipway 9mi.
Jetski slipway 330'

- **Amenities :**

Village centre 1.25mi.
Bike/mountain bike hire 6mi.
Car rental 6mi.
Boat rental 6mi.
Scuba diving material hire 6mi.
Household linens for hire/laundry services 6mi.
Breadshop 330'
Local shops 330'
Supermarket 9mi.
High class retailers 18.5mi.
Hairdressing salon 1.25mi.
Internet cafe 1.25mi.
Post office 1.25mi.
Bank 1.25mi.
Cash point 1.25mi.
Chemist 1.25mi.
Doctor 1.25mi.
Nurse 1.25mi.
Hospital 15.5mi.



Advert No. 76717

www.ihacom.co.uk





Interior

- **Receive up to :**
from 2 to 4 person(s) (2 adults, 2 children)
- **Liveable floor area :**
750 Sq.ft.
- **Interior layout :**
3 Room(s), 1 bedroom(s), 1 shower room, 1 WC, living room, sitting room, separate kitchen, dining room, dining area, tv room, veranda
- **Sleeps - bed(s) :**
1 double bed(s), 1 sofa bed(s) 2 pers
- **Guest facilities :**
T.V., telephone, internet access, wifi, cupboard, Hanging wardrobe, hair dryer, partly air conditioned, mobile cool air fan, Glazed in area, Curtains, Double glazed, Rolling shutters, entry phone system, fire alarm, remote controlled gates
- **Appliances :**
Crockery/cutlery, kitchen utensils, electric coffee maker, electric kettle, toaster, food processor, electric hobs, oven, micro-wave oven, extractor hood, refridgerator, freezer, dish washer, washing machine, vacuum cleaner, iron, ironing board

Exterior

- **Outside accommodation :**
Covered terrace
- **Outside setting :**
Private courtyard, enclosed grounds, garden
- **Outside amenities :**
Garden seated area, 1 chaise(s) longue(s)



Services

- **Washing :**
Sheets, Towels, Linen, Blanket(s)
- **House :**
Cleaning on departure supplement (+£89*), Parking

For your guidance

- **For your guidance**
No pet allowed
Non smoking rental, mobile telephone network coverage
Water : hot/cold
Local voltage supply : 220-240V / 50Hz
Electricity supply : mains



Floor plan

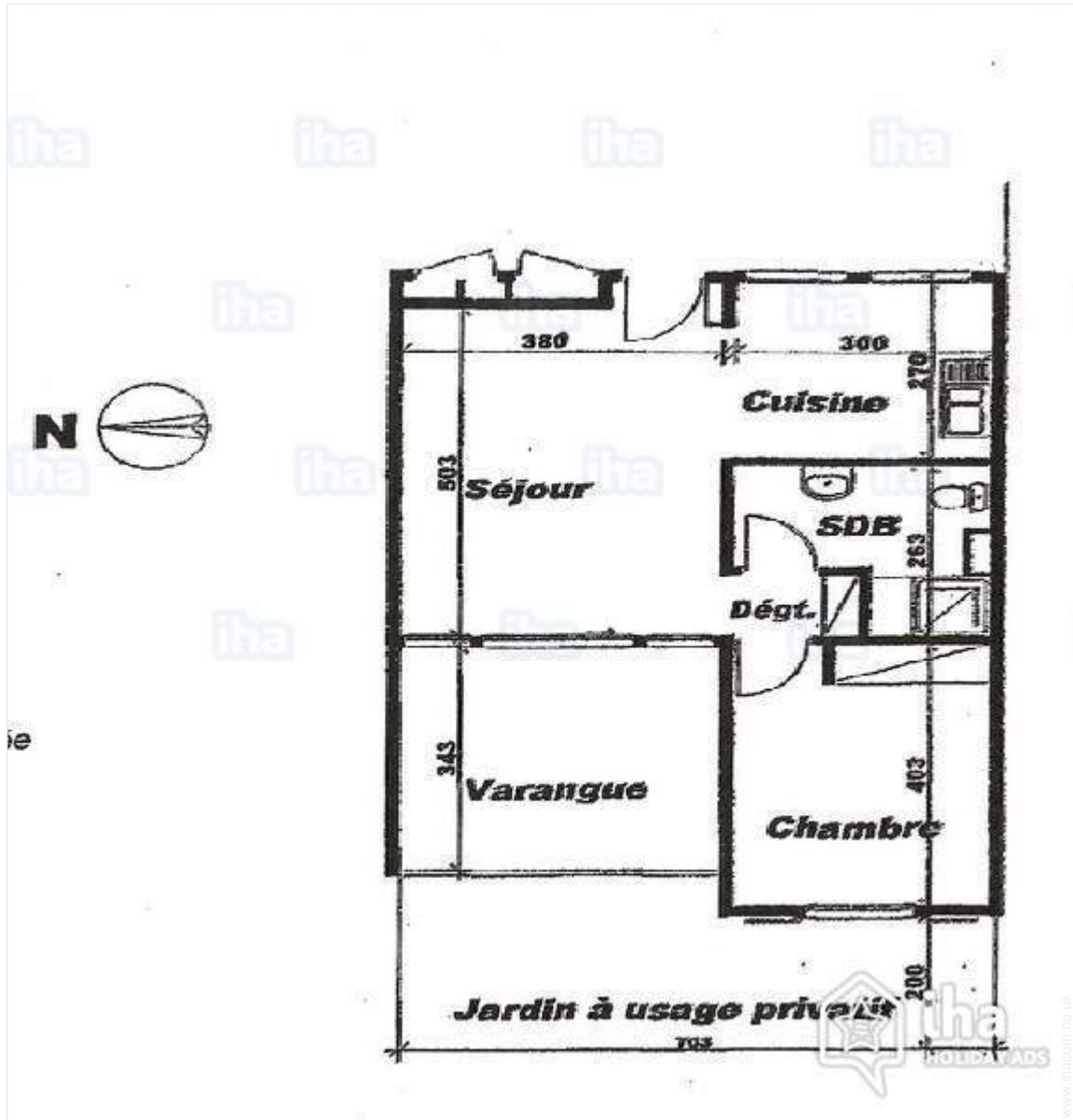

Photo album - 1



Holiday lettings
Sainte-Luce - Martinique
Flat-Apartments

6
[Book now](#)

Photo album - 2



Advert No. 76717

www.ihacom.co.uk



>> HOLIDAY LETTINGS

BOOK DIRECT WITH THE OWNERS

Holiday lettings
Sainte-Luce - Martinique
Flat-Apartments

7
[Book now](#)

Location



Location & Access



GPS coordinates in degrees, minutes, seconds: Latitude 14° 28'3"N - Longitude 60°56'21"W ([Dwelling](#))

Address

→ Corps de Garde
ZAC de Pont Café
97228 Sainte-Luce

● [Airport Martinique Aimé Césaire](#)

→ Fort-de-France, Martinique
→ Distance : 15mi.

- Le Marin : (6mi.)
- Rivière-Pilote : (6mi.)
- Le Lamentin : (12.5mi.)

Contact

Spoken languages



Holiday lettings Sainte-Luce - Martinique Flat-Apartments

8
[Book now](#)

Availability calendar - from : september 2018

Sep	Sa	Su	M	Tu	W	Th	F	Sa	Su	M	Tu	W	Th	F	Sa	Su	M	Tu	W	Th	F	Sa	Su	M	Tu	W	Th	F	Sa	Su	
2018	1	2	3	4	5	6	7	8	9	10	11	12	13	14	15	16	17	18	19	20	21	22	23	24	25	26	27	28	29	30	
																				-	-	-	-	-	-	-	-	-	-	-	-

Oct	M	Tu	W	Th	F	Sa	Su	M	Tu	W	Th	F	Sa	Su	M	Tu	W	Th	F	Sa	Su	M	Tu	W	Th	F	Sa	Su	M	Tu	W	
2018	1	2	3	4	5	6	7	8	9	10	11	12	13	14	15	16	17	18	19	20	21	22	23	24	25	26	27	28	29	30	31	
	-	-	-	-	-	-	-	-	-	-	-	-	-	-	-	-	-	-	-	-	-	-	-	-	-	-	-	-	-	-	-	

Nov	Th	F	Sa	Su	M	Tu	W	Th	F	Sa	Su	M	Tu	W	Th	F	Sa	Su	M	Tu	W	Th	F	Sa	Su	M	Tu	W	Th	F	
2018	1	2	3	4	5	6	7	8	9	10	11	12	13	14	15	16	17	18	19	20	21	22	23	24	25	26	27	28	29	30	
	-	-	-	-	-	-	-	-	-	-	-	-	-	-	-	-	-	-	-	-	-	-	-	-	-	-	-	-	-	-	

Dec	Sa	Su	M	Tu	W	Th	F	Sa	Su	M	Tu	W	Th	F	Sa	Su	M	Tu	W	Th	F	Sa	Su	M	Tu	W	Th	F	Sa	Su	M	
2018	1	2	3	4	5	6	7	8	9	10	11	12	13	14	15	16	17	18	19	20	21	22	23	24	25	26	27	28	29	30	31	
	-	-	-	-	-	-	-	-	-	-	-	-	-	-	-	-	-	-	-	-	-	-	-	-	-	-	-	-	-	-	-	

Jan	Tu	W	Th	F	Sa	Su	M	Tu	W	Th	F	Sa	Su	M	Tu	W	Th	F	Sa	Su	M	Tu	W	Th	F	Sa	Su	M	Tu	W	Th	
2019	1	2	3	4	5	6	7	8	9	10	11	12	13	14	15	16	17	18	19	20	21	22	23	24	25	26	27	28	29	30	31	
	-	-	-	-	-	-	-	-	-	-	-	-	-	-	-	-	-	-	-	-	-	-	-	-	-	-	-	-	-	-	-	

Feb	F	Sa	Su	M	Tu	W	Th	F	Sa	Su	M	Tu	W	Th	F	Sa	Su	M	Tu	W	Th	F	Sa	Su	M	Tu	W	Th	
2019	1	2	3	4	5	6	7	8	9	10	11	12	13	14	15	16	17	18	19	20	21	22	23	24	25	26	27	28	
	-	-	-	-	-	-	-	-	-	-	-	-	-	-	-	-	-	-	-	-	-	-	-	-	-	-	-	-	-

Mar	F	Sa	Su	M	Tu	W	Th	F	Sa	Su	M	Tu	W	Th	F	Sa	Su	M	Tu	W	Th	F	Sa	Su	M	Tu	W	Th	F	Sa	Su	
2019	1	2	3	4	5	6	7	8	9	10	11	12	13	14	15	16	17	18	19	20	21	22	23	24	25	26	27	28	29	30	31	
	-	-	-	-	-	-	-	-	-	-	-	-	-	-	-	-	-	-	-	-	-	-	-	-	-	-	-	-	-	-	-	

Apr	M	Tu	W	Th	F	Sa	Su	M	Tu	W	Th	F	Sa	Su	M	Tu	W	Th	F	Sa	Su	M	Tu	W	Th	F	Sa	Su	M	Tu	
2019	1	2	3	4	5	6	7	8	9	10	11	12	13	14	15	16	17	18	19	20	21	22	23	24	25	26	27	28	29	30	
	-	-	-	-	-	-	-	-	-	-	-	-	-	-	-	-	-	-	-	-	-	-	-	-	-	-	-	-	-	-	

May	W	Th	F	Sa	Su	M	Tu	W	Th	F	Sa	Su	M	Tu	W	Th	F	Sa	Su	M	Tu	W	Th	F	Sa	Su	M	Tu	W	Th	F	
2019	1	2	3	4	5	6	7	8	9	10	11	12	13	14	15	16	17	18	19	20	21	22	23	24	25	26	27	28	29	30	31	
	-	-	-	-	-	-	-	-	-	-	-	-	-	-	-	-	-	-	-	-	-	-	-	-	-	-	-	-	-	-	-	

June	Sa	Su	M	Tu	W	Th	F	Sa	Su	M	Tu	W	Th	F	Sa	Su	M	Tu	W	Th	F	Sa	Su	M	Tu	W	Th	F	Sa	Su	
2019	1	2	3	4	5	6	7	8	9	10	11	12	13	14	15	16	17	18	19	20	21	22	23	24	25	26	27	28	29	30	
	-	-	-	-	-	-	-	-	-	-	-	-	-	-	-	-	-	-	-	-	-	-	-	-	-	-	-	-	-	-	

Holiday lettings Sainte-Luce - Martinique Flat-Apartments

9

[Book now](#)



Availability calendar - from : june 2019

Jul	M	Tu	W	Th	F	Sa	Su	M	Tu	W	Th	F	Sa	Su	M	Tu	W	Th	F	Sa	Su	M	Tu	W							
2019	1	2	3	4	5	6	7	8	9	10	11	12	13	14	15	16	17	18	19	20	21	22	23	24	25	26	27	28	29	30	31
-	-	-	-	-	-	-	-	-	-	-	-	-	-	-	-	-	-	-	-	-	-	-	-	-	-	-	-	-	-	-	

Aug	Th	F	Sa	Su	M	Tu	W	Th	F	Sa	Su	M	Tu	W	Th	F	Sa	Su	M	Tu	W	Th	F	Sa							
2019	1	2	3	4	5	6	7	8	9	10	11	12	13	14	15	16	17	18	19	20	21	22	23	24	25	26	27	28	29	30	31
-	-	-	-	-	-	-	-	-	-	-	-	-	-	-	-	-	-	-	-	-	-	-	-	-	-	-	-	-	-	-	

[Month : Next >>](#)

Rental rates - Flat-Apartments - from 2 to 4 Person(s)

Rates	Night	Weekend	week	2 weeks	Month
 Low season	-	-	£356*	£676*	-
 High season	-	-	£445*	£846*	-

[Book now](#)

Booking conditions

• Reservation

→ Payment made upon reservation :
30% of rental sum
→ Payment balance :
on handing over the keys

• rentals

→ Service charges included
→ Day tax included
→ Cleaning charge levy on departure : £89*

[▶ Book now](#)[▶ Contact the owner](#)

Accepted methods of payment

• Bank transfer (wire) • Cash

Contact directly the property owners

www.ihacom.co.uk

Advert No.

76717

[>> Book now <<](#)

Contact

Spoken languages



* Converted at the rate indicated : €100 = \$116.85 = £89

Advert No. 76717

www.ihacom.co.uk[>> HOLIDAY LETTINGS](#)

BOOK DIRECT WITH THE OWNERS