

Holiday lettings Les Deux-Alpes "L'OLYMPE"

2 Alpes, apartment 4/6 people, on foot of the ski tracks, Internet WIFI free.



www.ihacom.co.uk

Flat-Apartments 2nd floor, shared entrance, in a(an) Estate 4 floors

Setting : ski to door, pleasant

Capacity : 6 person(s)

Bedroom(s) : 1

Room(s) : 2



Clé vacances (3 keys)

Les Deux-Alpes - Isère (38) - Rhône-Alpes

France

Reservation : +33 (0) 6 18 42 60 56 (France)

Advert No. 28300

www.ihacom.co.uk



>> HOLIDAY LETTINGS

BOOK DIRECT WITH THE OWNERS

Holiday lettings



Flat-Apartments 2nd floor, shared entrance, in a(an) Estate 4 floors

- View : unobscured, not overlooked, mountain, street/avenue
- Setting : ski to door, pleasant
- Exposure : West

" Apartment equipped with a bedroom with 1 bed for 2 people and cupboards, a living room with 2 bunk beds, 1 click clas for 2 people. Flat screen TV, DVD player. A kitchen equipped with a dishwasher, a refrigerator, induction 3 lights, traditional oven, a microwave, a coffee maker, a kettle. Bathroom toilet. "

Assets

- Parking :
Parking uncovered : 1 internal.
- Advantages :
Ski locker



living room

Surroundings & location



Mountain



Ski

" 75 km from Grenoble by road. Bus stop from Grenoble at the foot of the building. 75 lifts. Many summer activities. Opening season November 29 until April 25. "

Leisure

- Leisure activities less than 20 km / 12 miles :

Alpine skiing, ski-trekking, snowboarding, luge (run), skidoo, bathing, canoeing, rafting, golf, tennis, riding school, hiking, paragliding, horse trekking, mini-golf, ten-pin bowling, fishing

- Supervised :

Ski school, childs ski area

Surroundings

- Locality :

Ski slopes <165'
Ski lifts 330'
Ice skating rink 0.3mi.



separate kitchen



living room



master bedroom

Interior

- **Receive up to :**
6 person(s) (4 adults, 2 children)
- **Liveable floor area :**
410 Sq.ft.
- **Interior layout :**
2 Room(s), 1 bedroom(s), 1 shower room, living room 215 Sq.ft., sitting room 110 Sq. ft., separate kitchen
- **Sleeps - bed(s) :**
1 double bed(s), 1 sofa bed(s) 2 pers, 1 bunk beds
- **Guest facilities :**
Lift, T.V., DVD player, t.v points, internet access, wifi, cupboard, Hanging wardrobe, hair dryer, central heating, electric heating, Glazed in area, Curtains, electric shutters, remote controlled gates
- **Appliances :**
Crockery/cutlery, kitchen utensils, cafetiere, electric coffee maker, toaster, juicer, food processor, crepe maker, electric raclette set, electric hobs, oven, micro-wave oven, extractor hood, refridgerator, dish washer, vacuum cleaner, iron, ironing board

Exterior

- **Outside accommodation :**
Balcony 120 Sq.ft.



view from the flat

Services

- **House :**
Caretaker/concierge, Parking

For your guidance

- **For your guidance**
Pets accepted under certain conditions (ask the owner)
Mobile telephone network coverage, personal transport advisable
Water : hot/cold
Local voltage supply : 110-120V / 60Hz
Electricity supply : mains



shower room

Floor plan

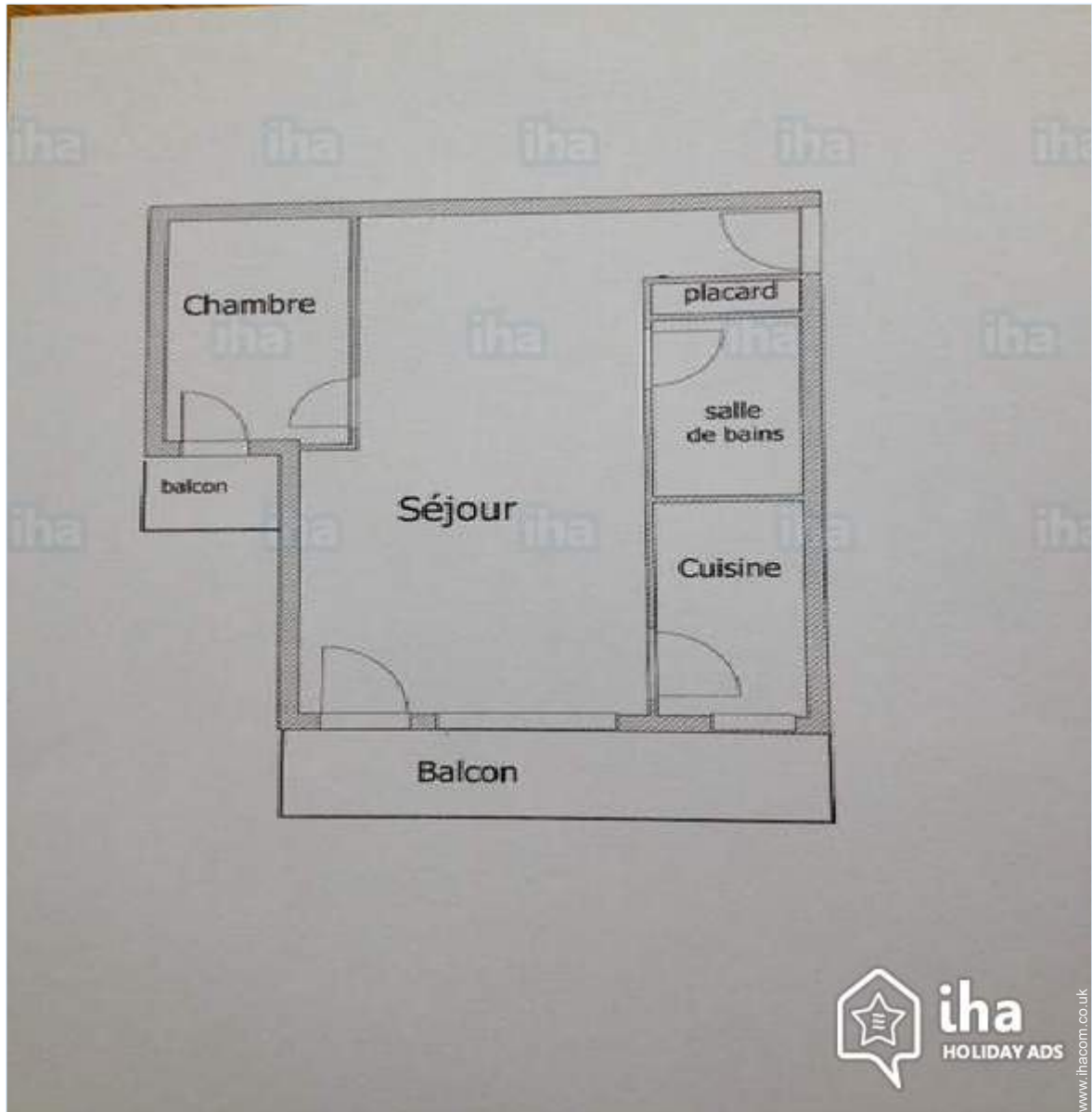

Photo album - 1



living room



living room



separate kitchen

Photo album - 2



master bedroom



shower room



view from the flat



view from the flat



block of flats

Route map

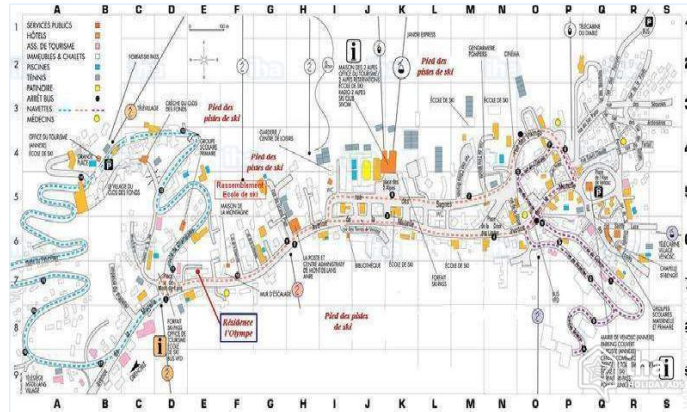

Location & Access

" Foot of the ski tracks and the meeting place of the Champame ski school. "



GPS coordinates in degrees, minutes, seconds: Latitude 45° 1'1"N - Longitude 6°7'29"E ([Dwelling](#))

Address

→ Résidence L'Olympe
24 Avenue de la Muzelle
38860 Les Deux-Alpes

• Coach station TOUTIN

→ Grenoble, Isère, Rhône-Alpes, France
→ Distance : 43,5mi.
→ Time : 1h30'

• Grenoble : (43,5mi.)

Contact

Spoken languages



Location

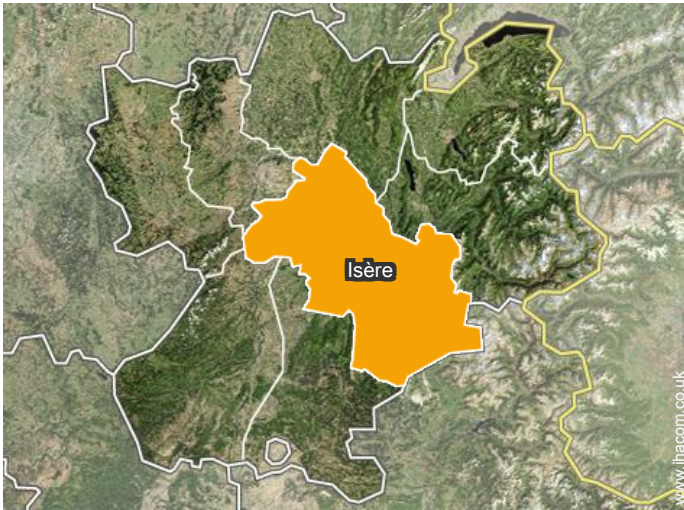

Holiday lettings Les Deux-Alpes - France "L'OLYMPE"

[Book now](#)

Availability calendar - from : march 2018

Mar	Th	F	Sa	Su	M	Tu	W	Th	F	Sa	Su	M	Tu	W	Th	F	Sa	Su	M	Tu	W	Th	F	Sa	Su	M	Tu	W	Th	F	Sa
2018	1	2	3	4	5	6	7	8	9	10	11	12	13	14	15	16	17	18	19	20	21	22	23	24	25	26	27	28	29	30	31
																	-	-	-	-	-	-	-	-	-	-	-	-	-	-	-

Apr	Su	M	Tu	W	Th	F	Sa	Su	M	Tu	W	Th	F	Sa	Su	M	Tu	W	Th	F	Sa	Su	M							
2018	1	2	3	4	5	6	7	8	9	10	11	12	13	14	15	16	17	18	19	20	21	22	23	24	25	26	27	28	29	30
	-	-	-	-	-	-	-	-	-	-	-	-	-	-	-	-	-	-	-	-	-	-	-	-	-	-	-	-	-	-

May	Tu	W	Th	F	Sa	Su	M	Tu	W	Th	F	Sa	Su	M	Tu	W	Th	F	Sa	Su	M	Tu	W	Th							
2018	1	2	3	4	5	6	7	8	9	10	11	12	13	14	15	16	17	18	19	20	21	22	23	24	25	26	27	28	29	30	31
	-	-	-	-	-	-	-	-	-	-	-	-	-	-	-	-	-	-	-	-	-	-	-	-	-	-	-	-	-	-	

June	F	Sa	Su	M	Tu	W	Th	F	Sa	Su	M	Tu	W	Th	F	Sa	Su	M	Tu	W	Th	F	Sa							
2018	1	2	3	4	5	6	7	8	9	10	11	12	13	14	15	16	17	18	19	20	21	22	23	24	25	26	27	28	29	30
	-	-	-	-	-	-	-	-	-	-	-	-	-	-	-	-	-	-	-	-	-	-	-	-	-	-	-	-	-	-

Jul	Su	M	Tu	W	Th	F	Sa	Su	M	Tu	W	Th	F	Sa	Su	M	Tu	W	Th	F	Sa	Su	M	Tu							
2018	1	2	3	4	5	6	7	8	9	10	11	12	13	14	15	16	17	18	19	20	21	22	23	24	25	26	27	28	29	30	31
	-	-	-	-	-	-	-	-	-	-	-	-	-	-	-	-	-	-	-	-	-	-	-	-	-	-	-	-	-	-	

Aug	W	Th	F	Sa	Su	M	Tu	W	Th	F	Sa	Su	M	Tu	W	Th	F	Sa	Su	M	Tu	W	Th	F							
2018	1	2	3	4	5	6	7	8	9	10	11	12	13	14	15	16	17	18	19	20	21	22	23	24	25	26	27	28	29	30	31
	-	-	-	-	-	-	-	-	-	-	-	-	-	-	-	-	-	-	-	-	-	-	-	-	-	-	-	-	-	-	

Sep	Sa	Su	M	Tu	W	Th	F	Sa	Su	M	Tu	W	Th	F	Sa	Su	M	Tu	W	Th	F	Sa	Su							
2018	1	2	3	4	5	6	7	8	9	10	11	12	13	14	15	16	17	18	19	20	21	22	23	24	25	26	27	28	29	30
	-	-	-	-	-	-	-	-	-	-	-	-	-	-	-	-	-	-	-	-	-	-	-	-	-	-	-	-	-	-

Oct	M	Tu	W	Th	F	Sa	Su	M	Tu	W	Th	F	Sa	Su	M	Tu	W	Th	F	Sa	Su	M	Tu	W							
2018	1	2	3	4	5	6	7	8	9	10	11	12	13	14	15	16	17	18	19	20	21	22	23	24	25	26	27	28	29	30	31
	-	-	-	-	-	-	-	-	-	-	-	-	-	-	-	-	-	-	-	-	-	-	-	-	-	-	-	-	-	-	

Nov	Th	F	Sa	Su	M	Tu	W	Th	F	Sa	Su	M	Tu	W	Th	F	Sa	Su	M	Tu	W	Th	F							
2018	1	2	3	4	5	6	7	8	9	10	11	12	13	14	15	16	17	18	19	20	21	22	23	24	25	26	27	28	29	30
	-	-	-	-	-	-	-	-	-	-	-	-	-	-	-	-	-	-	-	-	-	-	-	-	-	-	-	-	-	-

Dec	Sa	Su	M	Tu	W	Th	F	Sa	Su	M	Tu	W	Th	F	Sa	Su	M	Tu	W	Th	F	Sa	Su	M							
2018	1	2	3	4	5	6	7	8	9	10	11	12	13	14	15	16	17	18	19	20	21	22	23	24	25	26	27	28	29	30	31
	-	-	-	-	-	-	-	-	-	-	-	-	-	-	-	-	-	-	-	-	-	-	-	-	-	-	-	-	-	-	



Holiday lettings Rhône-Alpes - Les Deux-Alpes "L'OLYMPE"

10
[Book now](#)



Availability calendar - from : december 2018

Jan	Tu	W	Th	F	Sa	Su	M	Tu	W	Th	F	Sa	Su	M	Tu	W	Th	F	Sa	Su	M	Tu	W	Th							
2019	1	2	3	4	5	6	7	8	9	10	11	12	13	14	15	16	17	18	19	20	21	22	23	24	25	26	27	28	29	30	31
-	-	-	-	-	-	-	-	-	-	-	-	-	-	-	-	-	-	-	-	-	-	-	-	-	-	-	-	-	-	-	

Feb	F	Sa	Su	M	Tu	W	Th	F	Sa	Su	M	Tu	W	Th	F	Sa	Su	M	Tu	W	Th								
2019	1	2	3	4	5	6	7	8	9	10	11	12	13	14	15	16	17	18	19	20	21	22	23	24	25	26	27	28	
-	-	-	-	-	-	-	-	-	-	-	-	-	-	-	-	-	-	-	-	-	-	-	-	-	-	-	-	-	-

[Month : Next >>](#)

Rental rates - Flat-Apartments - 6 Person(s)

Rates	Night	Weekend	week	2 weeks	Month
 Low season	-	-	£187* (Saturday)	-	-
 Mid season	-	-	£329* (Saturday)	£400*	-
 High season	-	-	£712* (Saturday)	-	-
 Festive specials	-	-	£356* (Saturday)	-	-
 Promotional period	-	-	£409* (Saturday)	-	-

(Check-in day)

[Book now](#)



separate kitchen



master bedroom



shower room



living room



living room



Booking conditions

• Reservation

- Payment made upon reservation : 30% of rental sum
- Payment balance : on handing over the keys
- Deposit required : £267*

• rentals

- Service charges included
- Day tax included

Accepted methods of payment

- Cheque

Contact

Spoken languages



▶ [Book now](#)

▶ [Contact the owner](#)

Contact directly the property owners

www.ihacom.co.uk

Advert No.

28300

>> [Book now](#) <<

* Converted at the rate indicated : €100 = \$123.46 = £88.94

Advert No. 28300

www.ihacom.co.uk

