

Charming holiday letting Interlaken "CityChalet"



Charming Wooden Chalet, detached,
1 floor, separate entrance, in a(an) Private
property

Setting : suitable for a relaxing break,
mountainy

Capacity : **10 person(s)**

Bedroom(s) : **4**

Room(s) : **5**

Interlaken - Canton of Berne

Switzerland

Reservation : +41 (0) 33 8210546 (Switzerland)

Advert No. 6287

www.ihacom.co.uk



>> HOLIDAY LETTINGS

BOOK DIRECT WITH THE OWNERS

Charming holiday letting



Charming Wooden Chalet, detached, 1 floor, separate entrance, in a(an) Private property

- **Ideal for family groups, large families**
- **View** : panoramic, unobscured, mountain, forest, river, village
- **Setting** : suitable for a relaxing break, mountainy
- **Exposure** : South-west

Assets

- **Parking** :
Parking uncovered : 3 off road.
- **baby equipment** :
Baby chair, baby potty

Surroundings & location



Mountain Golf Horse riding Fishing



Festival Culture

Leisure

- **Leisure activities less than 20 km / 12 miles** :

Alpine skiing, cross-country skiing, ski-trekking, snowboarding, ice-skating, dogsledding, bathing, scuba diving, water skiing, sailing, canyoning, rafting, golf, tennis, squash, riding school, pathway, coastal/forest paths, hiking, climbing, rock climbing, parascending, parachuting, hang-gliding, paragliding, boat trips, horse-drawn carriage, horse trekking, mini-golf, ten-pin bowling

- **Supervised** :

Ski school, child's ski area, sailing school, dive school, tennis school, riding school

- **Attractions and relaxation** :

Bar/pub, discotheque, restaurant, cinema, open air summer cinema, park and garden, leisure park, zoo/animal park, sea world, nature reserve, exhibition centre, art gallery, historical site, museum, theatre, summer theatre, festivals, antiques & bric-a-brac, local craftshop, cellar and wine tasting, casino, natural spring baths, sauna, steam baths, health farm, beauticians, fitness centre, Bio farm

Surroundings

- **Locality** :

Ski slopes 12.5mi.
Ice skating rink 1.5mi.
Heated swimming pool 0.5mi.
Shingle beach 2.5mi.
Rocky beach 2.5mi.
Public swimming pool 0.5mi.
Public tennis court 0.5mi.
9 hole golf course 2.5mi.
Watersports centre 2.5mi.
Waterfall 9mi.
River <165'
Lake 2.5mi.
Forest 0.3mi.
Mountain range 0.5mi.
Marina 2.5mi.

- **Amenities** :

Nursery 0.3mi.
Village centre 0.3mi.
Town centre 0.3mi.
Bus stop / bus station 990'
Ski bus pick up point 0.3mi.
Bike/mountain bike hire 990'
Scooter/motorbike hire 990'
Car rental 0.62mi.
Boat rental 2.5mi.

Ski hire shop 0.3mi.
Scuba diving material hire 2.5mi.
Household linens for hire/laundry services 990'
Breadshop 990'
Caterer 660'
Local shops 660'
Supermarket <165'
High class retailers 0.3mi.
Hairdressing salon 660'
Internet cafe 990'
Post office 0.3mi.
Bank 0.3mi.
Cash point 0.3mi.
Chemist 0.3mi.
Doctor 990'
Nurse 0.3mi.
Hospital 0.93mi.
Dispensing clinic 0.93mi.



bedroom



bedroom



bedroom



bedroom

Interior

- **Receive up to :**
10 person(s)
- **Liveable floor area :**
1,600 Sq.ft.
- **Interior layout :**
5 Room(s), 4 bedroom(s), 2 bathroom, 2 WC, living room 270 Sq.ft., sitting room, separate kitchen, dining area, tv room, reading room, veranda
- **Sleeps - bed(s) :**
1 double bed(s), 8 single bed(s), 1 baby cot (s)
- **Guest facilities :**
T.V., hi-fi system, DVD player, board games, book collection, t.v points, computer, cable/satellite, internet access, high speed internet access, wifi, wardrobe, cupboard, Hanging wardrobe, radio alarmclock, hair dryer, central heating, Curtains, Double glazed, burgular alarm, fire alarm
- **Appliances :**
Crockery/cuttlery, kitchen utensils, cafetiere, electric coffee maker, electric kettle, toaster, juicer, food processor, electric raclette set, fondue set, electric cooker, electric hobs, oven, micro-wave oven, extractor hood, refridgerator, freezer, dish washer, washing machine, clothes dryer, vacuum cleaner, iron, ironing board

Exterior

- **Ground surface :**
0.37 acre
- **Outside accommodation :**
Balcony 65 Sq.ft.
- **Outside setting :**
Enclosed grounds 0.37 acre, garden 530 Sq.ft., lawn 215 Sq.ft., natural pools, river, wells/spring
- **Outside amenities :**
BBQ, garden table(s), 6 garden seat(s)



living room

Services

- **Washing :**
Sheets, Towels, Linen, Blanket(s), Quilt(s), Pillows
- **House :**
Cleaning on departure supplement (+£51*), Parking, Airport transfers supplement (+£118*)
- **Restauration :**
Breakfast supplement (+£8*), Half board supplement (+£25*), Full board supplement (+£35*)

For your guidance

- **For your guidance**
Children welcome
Pets accepted under certain conditions (ask the owner)
Non smoking rental, mobile telephone network coverage
Water : hot/cold
Local voltage supply : 220-240V / 50Hz
Electricity supply : mains
- **Handicapped people welcome**
Fitted out for the disabled : hard of hearing, mentally



kitchen

Floor plan

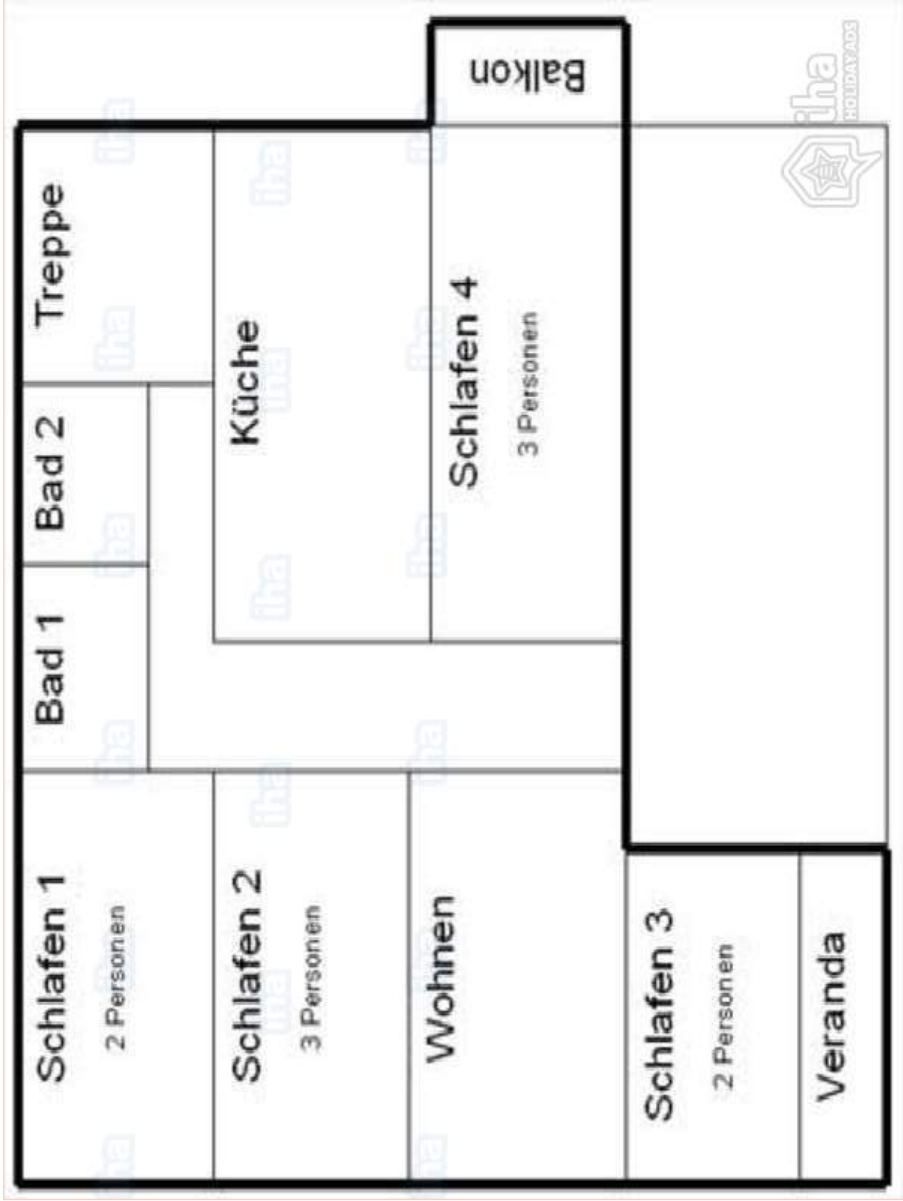

www.ihacom.co.uk



Photo album - 1



bedroom



bedroom



bedroom



bedroom

Photo album - 2



kitchen



living room



Winter



Summer



Winter



town centre

Route map



Location & Access



GPS coordinates in degrees, minutes, seconds: Latitude 46° 41'12.5"N - Longitude 7°51'9"E ([Dwelling](#))

Address

→ Marktgasse 66
3800 Interlaken

• Train station Interlaken West

→ Interlaken, Canton of Berne, Switzerland
→ Distance : 0.3mi.
→ Time : 5'

• Airport Zürich Kloten

→ Zürich, Canton of Zürich, Switzerland
→ Distance : 92mi.
→ Time : 1h45'

• Motorway (junction) Interlaken

→ Interlaken, Canton of Berne, Switzerland
→ Distance : 1.85mi.
→ Time : 5'

- Berne : (34mi.)
- Lucerne : (37,3mi.)
- Zürich : (92mi.)

Contact

Spoken languages



Charming holiday letting
Canton of Berne - Switzerland
"CityChalet"

[Book now](#)

Location



Charming holiday letting
Interlaken - Switzerland
"CityChalet"

Availability calendar - from : december 2017

| Dec | F | Sa | Su | M | Tu | W | Th | F | Sa | Su | M | Tu | W | Th | F | Sa | Su | M | Tu | W | Th | F | Sa | Su | | | | | | | |
|------|---|----|----|---|----|---|----|---|----|----|----|----|----|----|----|----|----|----|----|----|----|----|----|----|----|----|----|----|----|----|----|
| 2017 | 1 | 2 | 3 | 4 | 5 | 6 | 7 | 8 | 9 | 10 | 11 | 12 | 13 | 14 | 15 | 16 | 17 | 18 | 19 | 20 | 21 | 22 | 23 | 24 | 25 | 26 | 27 | 28 | 29 | 30 | 31 |
| | | | | | | | | | | | | | | | | | | | | | | | | | | | | | | | |

| Jan | M | Tu | W | Th | F | Sa | Su | M | Tu | W | Th | F | Sa | Su | M | Tu | W | Th | F | Sa | Su | M | Tu | W | Th | F | Sa | Su | M | Tu | W | |
|------|---|----|---|----|---|----|----|---|----|----|----|----|----|----|----|----|----|----|----|----|----|----|----|----|----|----|----|----|----|----|----|--|
| 2018 | 1 | 2 | 3 | 4 | 5 | 6 | 7 | 8 | 9 | 10 | 11 | 12 | 13 | 14 | 15 | 16 | 17 | 18 | 19 | 20 | 21 | 22 | 23 | 24 | 25 | 26 | 27 | 28 | 29 | 30 | 31 | |
| | | | | | | | | | | | | | | | | | | | | | | | | | | | | | | | | |

| Feb | Th | F | Sa | Su | M | Tu | W | Th | F | Sa | Su | M | Tu | W | Th | F | Sa | Su | M | Tu | W | | | | | | | | | | |
|------|----|---|----|----|---|----|---|----|---|----|----|----|----|----|----|----|----|----|----|----|----|----|----|----|----|----|----|----|--|--|--|
| 2018 | 1 | 2 | 3 | 4 | 5 | 6 | 7 | 8 | 9 | 10 | 11 | 12 | 13 | 14 | 15 | 16 | 17 | 18 | 19 | 20 | 21 | 22 | 23 | 24 | 25 | 26 | 27 | 28 | | | |
| | | | | | | | | | | | | | | | | | | | | | | | | | | | | | | | |

| Mar | Th | F | Sa | Su | M | Tu | W | Th | F | Sa | Su | M | Tu | W | Th | F | Sa | Su | M | Tu | W | Th | F | Sa | | | | | | | |
|------|----|---|----|----|---|----|---|----|---|----|----|----|----|----|----|----|----|----|----|----|----|----|----|----|----|----|----|----|----|----|----|
| 2018 | 1 | 2 | 3 | 4 | 5 | 6 | 7 | 8 | 9 | 10 | 11 | 12 | 13 | 14 | 15 | 16 | 17 | 18 | 19 | 20 | 21 | 22 | 23 | 24 | 25 | 26 | 27 | 28 | 29 | 30 | 31 |
| | | | | | | | | | | | | | | | | | | | | | | | | | | | | | | | |

| Apr | Su | M | Tu | W | Th | F | Sa | Su | M | Tu | W | Th | F | Sa | Su | M | Tu | W | Th | F | Sa | Su | M | Tu | W | Th | F | Sa | Su | M | |
|------|----|---|----|---|----|---|----|----|---|----|----|----|----|----|----|----|----|----|----|----|----|----|----|----|----|----|----|----|----|----|--|
| 2018 | 1 | 2 | 3 | 4 | 5 | 6 | 7 | 8 | 9 | 10 | 11 | 12 | 13 | 14 | 15 | 16 | 17 | 18 | 19 | 20 | 21 | 22 | 23 | 24 | 25 | 26 | 27 | 28 | 29 | 30 | |
| | | | | | | | | | | | | | | | | | | | | | | | | | | | | | | | |

| May | Tu | W | Th | F | Sa | Su | M | Tu | W | Th | F | Sa | Su | M | Tu | W | Th | F | Sa | Su | M | Tu | W | Th | F | Sa | Su | M | Tu | W | Th | |
|------|----|---|----|---|----|----|---|----|---|----|----|----|----|----|----|----|----|----|----|----|----|----|----|----|----|----|----|----|----|----|----|--|
| 2018 | 1 | 2 | 3 | 4 | 5 | 6 | 7 | 8 | 9 | 10 | 11 | 12 | 13 | 14 | 15 | 16 | 17 | 18 | 19 | 20 | 21 | 22 | 23 | 24 | 25 | 26 | 27 | 28 | 29 | 30 | 31 | |
| | | | | | | | | | | | | | | | | | | | | | | | | | | | | | | | | |

| June | F | Sa | Su | M | Tu | W | Th | F | Sa | Su | M | Tu | W | Th | F | Sa | Su | M | Tu | W | Th | F | Sa | Su | | | | | | | |
|------|---|----|----|---|----|---|----|---|----|----|----|----|----|----|----|----|----|----|----|----|----|----|----|----|----|----|----|----|----|----|--|
| 2018 | 1 | 2 | 3 | 4 | 5 | 6 | 7 | 8 | 9 | 10 | 11 | 12 | 13 | 14 | 15 | 16 | 17 | 18 | 19 | 20 | 21 | 22 | 23 | 24 | 25 | 26 | 27 | 28 | 29 | 30 | |
| | | | | | | | | | | | | | | | | | | | | | | | | | | | | | | | |

| Jul | Su | M | Tu | W | Th | F | Sa | Su | M | Tu | W | Th | F | Sa | Su | M | Tu | W | Th | F | Sa | Su | M | Tu | W | Th | F | Sa | Su | M | Tu | |
|------|----|---|----|---|----|---|----|----|---|----|----|----|----|----|----|----|----|----|----|----|----|----|----|----|----|----|----|----|----|----|----|--|
| 2018 | 1 | 2 | 3 | 4 | 5 | 6 | 7 | 8 | 9 | 10 | 11 | 12 | 13 | 14 | 15 | 16 | 17 | 18 | 19 | 20 | 21 | 22 | 23 | 24 | 25 | 26 | 27 | 28 | 29 | 30 | 31 | |
| | | | | | | | | | | | | | | | | | | | | | | | | | | | | | | | | |

| Aug | W | Th | F | Sa | Su | M | Tu | W | Th | F | Sa | Su | M | Tu | W | Th | F | Sa | Su | M | Tu | W | Th | F | Sa | Su | M | Tu | W | Th | F | |
|------|---|----|---|----|----|---|----|---|----|----|----|----|----|----|----|----|----|----|----|----|----|----|----|----|----|----|----|----|----|----|----|--|
| 2018 | 1 | 2 | 3 | 4 | 5 | 6 | 7 | 8 | 9 | 10 | 11 | 12 | 13 | 14 | 15 | 16 | 17 | 18 | 19 | 20 | 21 | 22 | 23 | 24 | 25 | 26 | 27 | 28 | 29 | 30 | 31 | |
| | | | | | | | | | | | | | | | | | | | | | | | | | | | | | | | | |

| Sep | Sa | Su | M | Tu | W | Th | F | Sa | Su | M | Tu | W | Th | F | Sa | Su | M | Tu | W | Th | F | Sa | Su | | | | | | | | |
|------|----|----|---|----|---|----|---|----|----|----|----|----|----|----|----|----|----|----|----|----|----|----|----|----|----|----|----|----|----|----|--|
| 2018 | 1 | 2 | 3 | 4 | 5 | 6 | 7 | 8 | 9 | 10 | 11 | 12 | 13 | 14 | 15 | 16 | 17 | 18 | 19 | 20 | 21 | 22 | 23 | 24 | 25 | 26 | 27 | 28 | 29 | 30 | |
| | | | | | | | | | | | | | | | | | | | | | | | | | | | | | | | |

■ Low season
 ■ High season
 ■ Mid season



Charming holiday letting
Interlaken - Switzerland
"CityChalet"

10
[Book now](#)

Availability calendar - from : september 2018

| Oct | M | Tu | W | Th | F | Sa | Su | M | Tu | W | Th | F | Sa | Su | M | Tu | W | Th | F | Sa | Su | M | Tu | W | Th | F | Sa | Su | M | Tu | W |
|------|---|----|---|----|---|----|----|---|----|----|----|----|----|----|----|----|----|----|----|----|----|----|----|----|----|----|----|----|----|----|----|
| 2018 | 1 | 2 | 3 | 4 | 5 | 6 | 7 | 8 | 9 | 10 | 11 | 12 | 13 | 14 | 15 | 16 | 17 | 18 | 19 | 20 | 21 | 22 | 23 | 24 | 25 | 26 | 27 | 28 | 29 | 30 | 31 |
| | - | - | - | - | - | - | - | - | - | - | - | - | - | - | - | - | - | - | - | - | - | - | - | - | - | - | - | - | - | - | - |

| Nov | Th | F | Sa | Su | M | Tu | W | Th | F | Sa | Su | M | Tu | W | Th | F | Sa | Su | M | Tu | W | Th | F | | | | | | | |
|------|----|---|----|----|---|----|---|----|---|----|----|----|----|----|----|----|----|----|----|----|----|----|----|----|----|----|----|----|----|----|
| 2018 | 1 | 2 | 3 | 4 | 5 | 6 | 7 | 8 | 9 | 10 | 11 | 12 | 13 | 14 | 15 | 16 | 17 | 18 | 19 | 20 | 21 | 22 | 23 | 24 | 25 | 26 | 27 | 28 | 29 | 30 |
| | - | - | - | - | - | - | - | - | - | - | - | - | - | - | - | - | - | - | - | - | - | - | - | - | - | - | - | - | - | - |

Low season High season Mid season

[Month : Next >>](#)

Rental rates - Charming Wooden Chalet - 10 Person(s)

| Rates | Night | Weekend | week | 2 weeks | Month |
|-------------|--------------|---------|--------|---------|--------|
| Low season | £268* > 3 | - | £1561* | £2886* | £5347* |
| Mid season | £308* > 3 | - | £1837* | £3438* | £6411* |
| High season | £300* > 5 | - | £2003* | £3769* | £7428* |

> Minimum Night

[Book now](#)

Booking conditions

• Reservation

→ Payment made upon reservation :
30% of rental sum
→ Payment balance :
on handing over the keys

• rentals

→ Service charges included
→ Day tax included
→ Cleaning charge on departure included

[▶ Book now](#)

[▶ Contact the owner](#)

Accepted methods of payment

• Visa/Delta/Electron • Switch/Maestro •
Bank transfer (wire) • MasterCard/
EuroCard • American Express • JCB •
PayPal • Cash

Contact directly the property owners

www.ihacom.co.uk

Advert No.

6287

[>> Book now <<](#)

Contact

Spoken languages



* Converted at the rate indicated : €100 = \$117.29 = £89.59

Advert No. 6287

www.ihacom.co.uk

